

GENCORE+

12mm Laminate

Reflections Laminate 12mm GenCore+ Flooring Installation Instructions

Reflections Laminate 12mm GenCore+ Flooring Installation Instructions

| | |
|--|------------|
| Acclimatisation & Site inspection | 3 |
| General information | 3-4 |
| Visual inspection and mixing planks | 5 |
| Preparation | 5 |
| - Subfloor | 5 |
| - Underlay | 5 |
| Installation instructions | 6 |
| - Getting started | 6 |
| - First row | 6 |
| - Second row | 6-7 |
| - Third row | 7 |
| - Completing the first three rows | 8 |
| - Continuing the rest of the installation | 8 |
| - Laying the last row | 9 |
| - Holes for pipes | 9 |
| - Door mouldings & skirting | 9 |
| - Under door frames | 9 |
| - Lifting or removing | 9 |
| - Finishing | 10 |

IMPORTANT NOTICE:

- Please read the entire installation instructions carefully before proceeding with the installation. If unsure, please contact your retailer or the manufacturer.
- Proceed with a visual inspection of the boards before installation. Once installed, the boards are considered accepted by the installer and the homeowner.
- Laminate Flooring must be installed as floating floor method **ONLY** and **CAN NOT** be glued, screwed, nailed, or fixed to the floor in any other fashion.
- Wet and dry electric vacuum cleaning method is **NOT ALLOWED** under any circumstances.
- The use of silicone or caulking compound is **NOT ALLOWED** throughout the installation.
- Minimum 10-12mm expansion gap is required around the perimeter at all times.
- Expansion Moulding: If the installation areas are greater than 16m in length and/or 10m in width or those with separate rooms, you will require the use of transition moulding to provide proper expansion space.
- **Avoid using solvents of any kind to clean the floor. Methylated Spirits, Turpentine, Bleach, Ammonia, Eucalyptus, Citrus, and/or similar solutions will damage the floor surface and will void the warranty.**

This instruction is a **GUIDE** only. If unsure, please contact your retailer.

Acclimatisation & Site inspection

- Reflections Laminate 12mm GenCore+ Flooring must be installed in a regulated and liveable environment to prevent possible damage not covered by warranty. As such, Reflections Laminate 12mm GenCore+ Flooring should not be installed more than 2 weeks prior to occupation of the home. The floor is designed to perform in an environmentally controlled structure.
- Please store the packets 48 hours prior to installation under the same climatic conditions (temperature and moisture) as the actual installation process.
- **IMPORTANT:** pre-condition for proper fitting and long-term durability of the Laminate Flooring is a room temperature between 15°C - 27°C and a relative humidity of around 45-60%.
- Avoid exposure to direct sunlight. Sliding doors and/or windows need to be covered by blinds or curtains.
- **DO NOT** install in bathrooms, laundries, toilets, or areas subject to regular moisture or water.
- Flooring should not be delivered until the building has been closed in and cement work, plastering, painting and other materials are completely dry. Concrete and plaster should be cured and at least 60 days old. Check basements and underfloor crawl spaces to ensure they are dry and well ventilated to avoid damage caused by moisture.
- Each plank should be carefully checked prior to installation. **DO NOT** install sub-standard, non-confirming or faulty boards. Do alignment inspections as you continue the installation.
- Handle with care. **DO NOT** stand packs on their ends.

- When the Reflections Laminate 12mm GenCore+ Flooring is ordered, allow approximately 5%-10% for wastage and off-cuts, depending upon size or layout of the room or installation area. (Please note diagonal installations may require additional wastage allowances).
- Extremes in humidity levels in the home must be prevented year-round. Laminate Flooring is a living product which reacts to humidity level variations. During summer, where the humidity level is usually at its highest point, the flooring is expected to expand as it absorbs moisture from the air. These variations must be dealt with adequate dehumidification. As for winter, when the heating system is working, the humidity level is lower. It is then recommended to use a humidifier to minimise the extreme effects of shrinkage.

General information

Reflections Laminate 12mm GenCore+ Flooring has been manufactured with a licenced click system, the planks can be clicked together without using any glue.

Before installing the flooring, you must clean, sweep, or vacuum the subfloor so that it is free of dirt and debris. Verify the moisture content of the subfloor using a moisture meter or another approved method.

Expansion Gap

When installing the Reflections Laminate 12mm GenCore+ Flooring, you must leave an expansion gap around the perimeter of the room of 10-12mm to prevent binding of the flooring. The planks must not be glued or tacked to the subfloor in any way.

This instruction is a **GUIDE** only. If unsure, please contact your retailer.

DO NOT INSTALL ANY CABINETS, KITCHEN ISLANDS OR ANY HEAVY ITEMS (ABOVE 200KG IN WEIGHT) ON TOP OF FLOATING LAMINATE FLOORS.

The 10-12mm expansion gap should be maintained when meeting other types of flooring. This also applies to any obstructions (columns, pipes, etc.) in the installation. Door jambs must be undercut to allow for expansion; **DO NOT** force the laminate product under tight door jambs.

Cutting the planks

When cutting Laminate Flooring with a circular saw, it is recommended to cut with the decorative side down. When using a table saw, jigsaw or handsaw, cut with the decorative side up.

Always start a row with a plank at least 400mm long and ensure the minimum end joint offset is 400mm apart.

Expansion Moulding

If the installation areas are greater than 16m in length and/or 10m in width or those with separate rooms, you will require the use of transition moulding to provide proper expansion space.

It is recommended to provide an expansion joint between different rooms (e.g. doorways) to allow for normal expansion and contraction.

Heated Slab

This laminate flooring can be installed over hydronic heated slabs. The floor must be installed by a professional installer, and always follow all the manufacturers' installation guidelines to make sure your warranty won't be comprised. Make sure the temperature of heated slab **DOES NOT EXCEED** 26°C at any time and increased/decreased by 2 degrees each day until reached your desired temperature. After floor installation is complete, the floor requires gradual acclimatisation in conjunction with the heating system.

NOTE: The heating system being used must be installed and operated in compliance with the guidelines of the heating and/or other manufacturers guidelines.

IMPORTANT: Please refer to the Reflections Laminate 12mm GenCore+ Flooring's "Heated Slab" installation instructions or contact your local retailer or manufacturer for more information.

Wet Areas

Laminate Flooring **CAN NOT** be installed in **ANY** wet areas including bathrooms, laundries, toilets, or areas subject to regular moisture or water.

Layout and measuring

First, determine which way to run the planks. Rules of thumb are:

- Lengthwise in the longest direction of the room.
- Lengthwise perpendicular to the main source of incoming light.

To avoid straddling a door jamb with a plank, measure back to the starting wall to ensure a plank connection within the door jamb area. Undercut all door jambs so that the flooring will easily slide underneath them. Using a scrap piece of flooring and underlayment as a guide, undercut the jambs with a jamb saw or regular handsaw. Always leave 10-12mm expansion gap between the flooring and all walls or other fixed objects.

It is recommended that you do not end up with a narrow strip at the end that is less than 50mm wide on any wall in the room. It is highly recommended to cut both first and last rows, so they are equal in width. The planks in the first row can be cut to a narrower width to ensure the planks of the final row are at least 50mm wide.

Tools Required

- Safety glasses
- Dust mask
- Measuring tape and square
- Ruler
- Sharp 'Stanley' type knife
- Pencil
- Pull bar
- Hammer
- Tapping block
- 'Table type' power saw with dust collector, or a circular saw with carbide-tipped blade, or a power jigsaw, multitool, drop saw, and undercut saw
- Small hand tools associated with woodworking
- Expansion wedges
- (Suitable sized spacer blocks of plastic or wood)
- Trims
- Scotia
- Stair Nosing
- **SelectUnderlay**
- **SelectGuard floor protection**
- Waterproof tape

This instruction is a **GUIDE** only. If unsure, please contact your retailer.

Visual inspection and mixing planks

Notice to installer

Planks showing visible defects should never be installed. These planks should be put aside and used for cuts or submitted for a product claim. Claims resulting from the installation of such planks will not be honoured. For best results, it is recommended that material be mixed from four (4) to six (6) boxes when installing the Reflections Laminate 12mm GenCore+ Flooring.

DO NOT PUT LIKE PLANKS NEXT TO EACH OTHER AND YOU MUST RANDOMLY STAGGER END JOINTS FOR BEST APPEARANCE.

Preparation

SUBFLOORS MUST BE CHECKED PRIOR TO INSTALLATION.

Subfloor

Reflections Laminate 12mm GenCore+ Flooring **CAN NOT** be installed over any existing flooring that has an attached cushion or is a floating floor such as carpet or carpet underlay. However, it can be installed over well-bond vinyl or ceramic tiles if sufficiently level. Tile grout joints or other gaps of more than 2mm in depth and 4mm in width should be levelled.

Please ensure the subfloor or surface that the flooring is being installed over is level. Using a 1m straightedge, the subfloor level should not exceed 3mm over 1 lineal metre in any direction. Remember, uneven floors may lead to movement and noise, so it is necessary to assess the levelness and get it right. Timber subfloors can be sanded level and concrete subfloors, or existing floor coverings can usually be levelled using a cement based self-levelling compound.

Wooden and wood-based materials (plywood, OSB, particle board) must be dry, with a moisture reading no greater than 14% (this should be checked with a moisture meter). All wooden subfloors must be greater than 19 mm thickness. Ensure that the boards of the subfloor are properly fastened to the supporting beams and that you do not have any squeaking or depressed areas. Patch if needed and fill depressed areas with floor levelling compound. Raised areas must be sanded down. The subfloor must be smooth, flat, structurally sound, and free of deflection.

Before installing any floor, a moisture level measurement of the subfloor is very important to know so that we can choose the correct installation procedure(s). If the moisture level is above 70% relative humidity as measured by an approved moisture meter that complies with the current Australian ATFA codes, you must first install a 200um minimum plastic moisture proof membrane or sheeting. Where the membrane edges meet, they must overlap by 300mm and the joints must be sealed using a waterproof tape. All walls and vertical fixtures must have the membrane turned up and then trimmed back to the appropriate level depending on skirting and/or beading to be installed.

SHOULD THE RELATIVE HUMIDITY OF THE SUBFLOOR BE ABOVE 85%, THE FLOORING SHOULD NOT BE INSTALLED.

Underlay

Reflections Laminate 12mm GenCore+ Flooring is installed by floating floor method and may not be glued, screwed, nailed, or fixed to the floor in any other fashion. All types of subfloors require moisture inhibiting membrane (underlay). A suitable underlay must be used on the subfloor prior to the Reflections Laminate 12mm GenCore+ Flooring installation.

The underlay must be applied with a minimum 100mm overlap and sealed with waterproof tape.

All walls and vertical fixtures must have the underlay turned up and then trimmed back to the appropriate level depending on skirting and/or beading to be installed.

Reflections Laminate 12mm GenCore+ Flooring Installation Instructions

This instruction is a **GUIDE** only. If unsure, please contact your retailer.

Installation

1. Getting started

Check the planks before you start to make sure that they are not in any way damaged or have quality defects. After cleaning the subfloor, you may roll a suitable underlay and must use its 100mm overlap and tape to ensure the moisture protection.

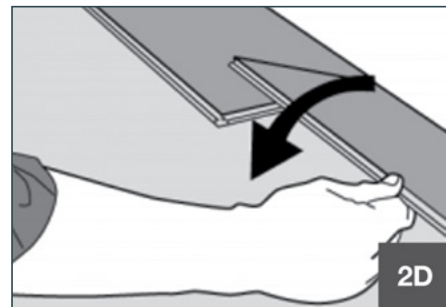
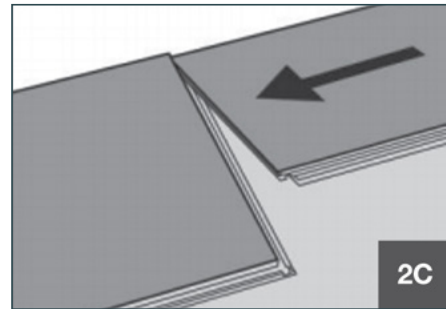
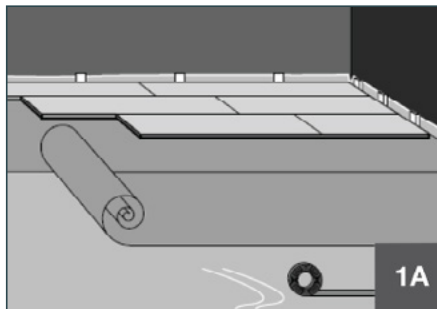

2. First row

Start installation of the planks in the right-hand corner, tongue-side against the wall. Make sure you place the short side of the plank 10-12mm from the wall. It is practical to adjust the gap between the long sides and the wall later, when three rows have been installed. Place next floorboard tight to the short end of the first one in the corner, then fold down with a single action movement. The planks will automatically click into place.

Repeat the same process for the next 3-4 planks and then start the second row. Ensure the long sides of the planks make a straight line.

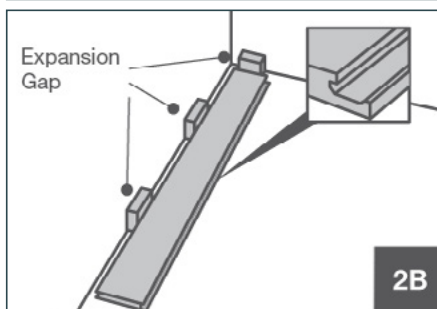
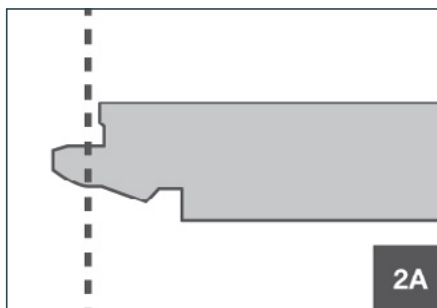

3. Second row

Use a cut piece of plank at least 400mm long from the previous row to start the next row. Always ensure that the end joints are randomly staggered at least 400mm. Place the next floorboard tight to the short end of the previous panel and fold down in a single action movement. The planks will automatically click into place.

Repeat the same for the next 3-4 planks and then start the third row.

Always ensure that the end joints are randomly staggered at least 400mm apart.

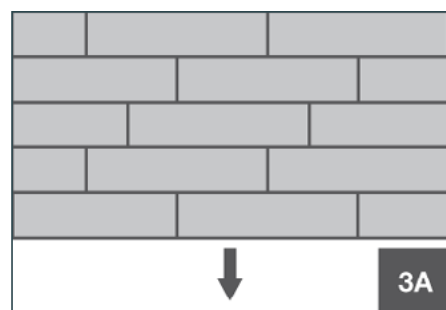

This instruction is a **GUIDE** only. If unsure, please contact your retailer.

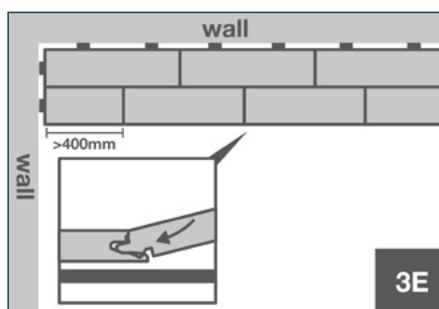
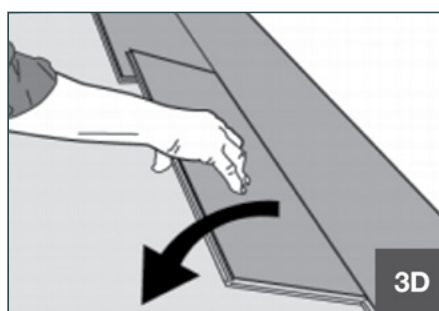
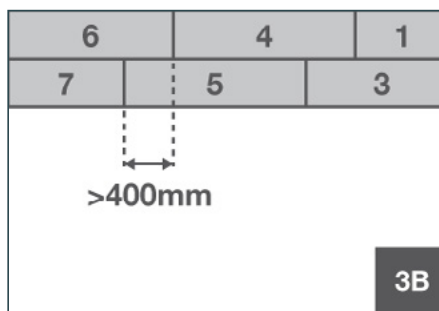

4. Third row

Start and complete the third row in same way as second row.

IMPORTANT: Now we can slide these three rows off the starting wall and install the suitable spacers against the starting walls. Make sure you leave minimum 10-12mm expansion from both walls.

It is critical to keep the first three rows straight and square as their alignment will affect the rest of the installation.

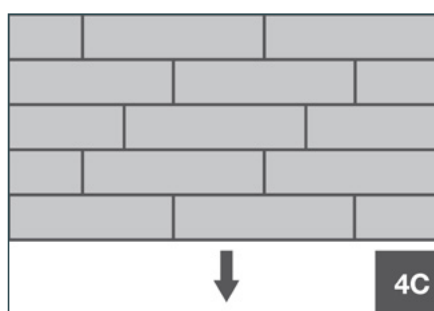
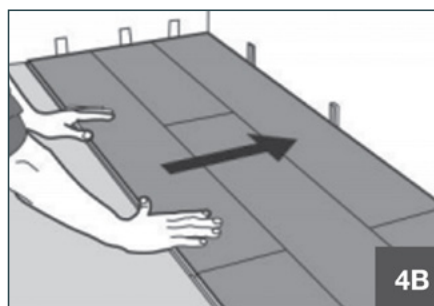
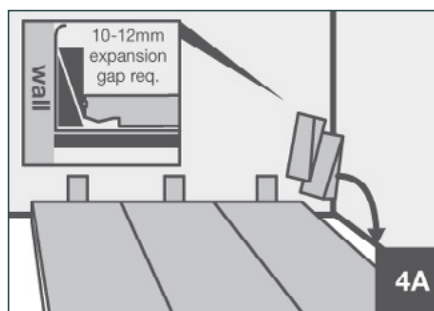

Always ensure that the end joints are randomly staggered at least 400mm apart.

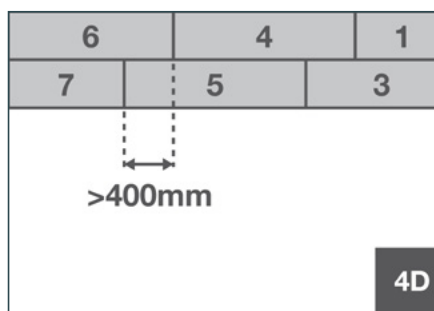

This instruction is a **GUIDE** only. If unsure, please contact your retailer.

5. Completing the first three rows

Move back to the first row and continue the installation. Place the final plank face down. The distance to the wall must be 10-12mm. Mark where the plank is to be cut. Place the plank face down on the work surface and cut to size using a circular saw. If you are using a hand saw, ensure that it is fine toothed and cut the plank face up.

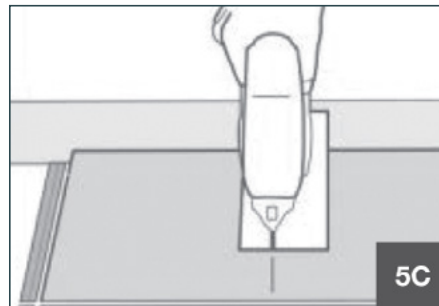
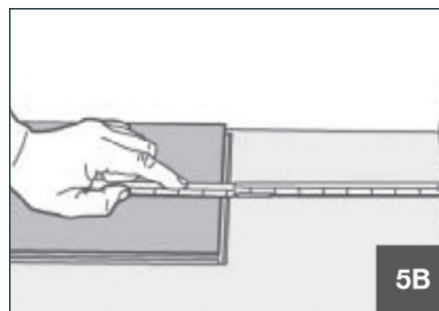
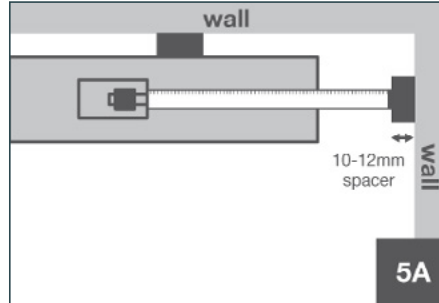

Always ensure that the end joints are randomly staggered at least 400mm apart.

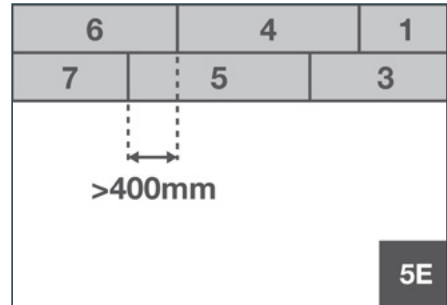
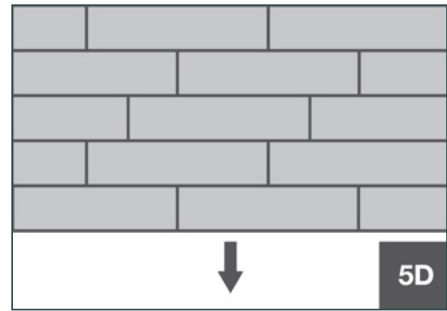

6. Continuing the rest of the installation

Repeat the same way row by row. Check to be certain that all planks are **FULLY ENGAGED**.

If gapping is noticed or the planks are not lying flat, simply disengage the long side by lifting up and then carefully lift the short side.

In some places where it is too difficult to install with the tapping block (e.g., against the wall), you can tap the planks together using a pull bar and hammer.

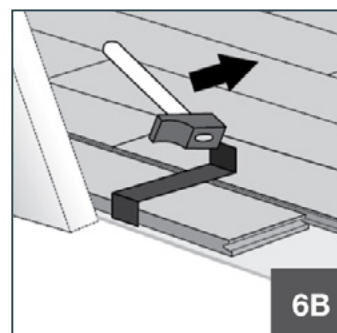
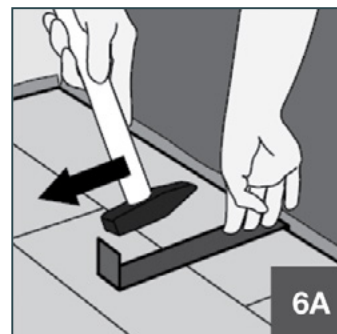

This instruction is a **GUIDE** only. If unsure, please contact your retailer.

7. Laying the last row

Measure and cut the plank, it must be a minimum 50mm in width. Leave a 10-12mm expansion gap to the wall.

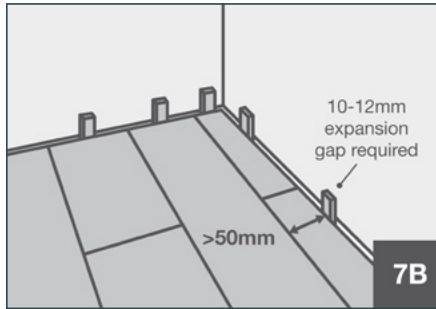
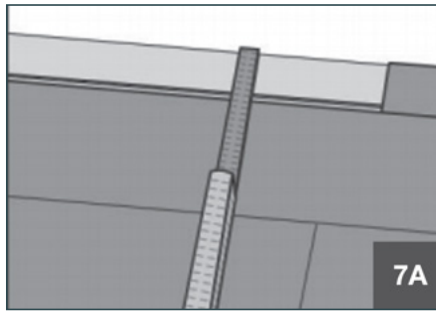

8. Holes for pipes

Measure the diameter of the pipe and drill a hole that is 20-24mm larger for the expansion. Saw off a piece and lay the plank in place on the floor.

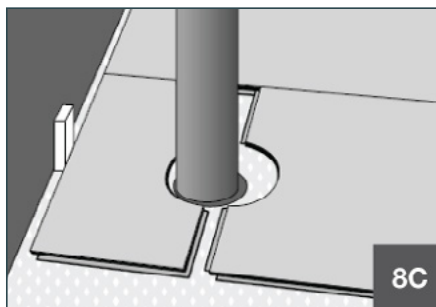
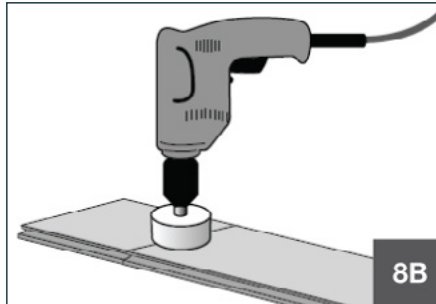
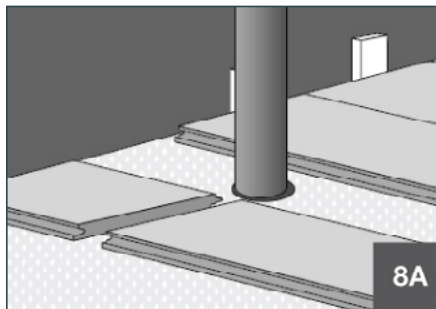

9. Door moulding & skirting

Lay a plank, with the decorative side down, next to the door moulding to measure where it is to be cut. Cut and remove the door jamb and slide the plank under the moulding.

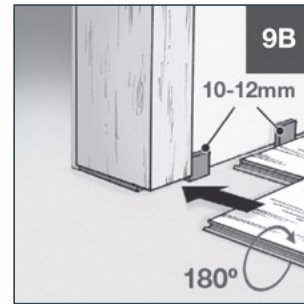
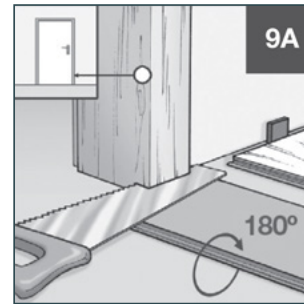

10. Under door frames

Ensure that the expansion joint under the door is at least 10-12mm. If the planks cannot be lifted, gently use a tapping block or pulling iron and hammer to tap the planks together with the planks flat against the floor until they click into place.

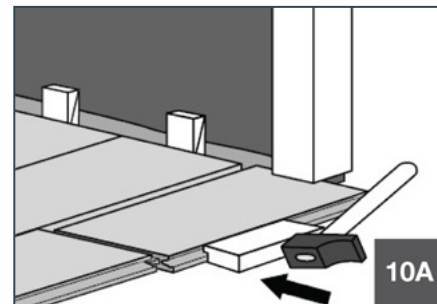

11. Lifting or removing

It is possible to remove or replace planks that have been laid as floating flooring in living areas and commercial areas without causing damage by the first releasing the whole row along the long side by angling it to free it from the locking mechanism. The planks can be separated from one another by lifting the tongue side out of the groove and removing laterally. Please be particularly diligent and careful when undertaking this work to avoid any damaging the locking systems.

This instruction is a **GUIDE** only. If unsure, please contact your retailer.

12. Finishing

Remove all the spacers, trim the underlay and make sure the 10-12mm expansion gap is left around the perimeter. Install the colour-matched scotia, skirting boards and other mouldings against the wall. Scotia is to be pinned to the skirting only, so it does not inhibit the free movement of the floor. If skirting boards have been removed or are yet to be fitted, they will usually cover the expansion gap well.

IMPORTANT: THE USE OF SILICONE OR CAULKING COMPOUND IS NOT ALLOWED AROUND THE PERIMETER OF THE INSTALLATION.

Install any end, connector, or adaptor profiles that have not been fitted during the installation process. These trims must hold the floor in place and provide for full and free expansion of the flooring under or inside the trim profile.

IMPORTANT: During the installation of scotias, skirting boards, trims, and door jambs, ensure no downward pressure is applied to the boards. It is recommended that a minimum 0.5mm gap allowance is given where the accessories meet the boards.

Please always visit our website www.asttimbers.com.au for the most up-to date version of this installation instructions, warranty, and care & maintenance as it may have been revised and updated.

GENCORE+

12mm Laminate